

THIS DRAWING IS THE PROPERTY OF DELAP & WALLER AND MAY ONLY BE USED WITH THEIR WRITTEN APPROVAL.

DO NOT SCALE FROM THIS DRAWING.

GENERAL NOTES.

THIS DRAWING TO BE READ IN CONJUNCTION WITH ALL OTHER RELEVANT DRAWINGS AND SPECIFICATIONS ALL DIMENSIONS ARE IN MILLIMETRES UNLESS OTHERWISE STATED.

THIS DRAWING IS NOT AN INSTALLATION DRAWING. THE CONTRACTOR SHALL BE RESPONSIBLE FOR THE PRODUCTION OF FABRICATION AND INSTALLATION DRAWINGS. SHALL BE FAMILIAR WITH OTHER WORKS PACKAGES WHICH DIRECTLY INTERFERE WITH HIS PACKAGE AND COORDINATE WITH THE FABRICATION AND INSTALLATION DRAWINGS ACCORDINGLY.

THE CONTRACTOR SHALL BE RESPONSIBLE FOR THE DESIGN, SUPPLY AND INSTALLATION OF SUPPORTS, BRACKETING SYSTEMS, AND SECONDARY STEELWORK SUPPORTS REQUIRED FOR THIS WORKS PACKAGE, UNLESS OTHERWISE STATED.

SHOULD ANY DISCREPANCIES BE APPARENT IN THIS DRAWING, THE ENGINEER SHALL BE MADE AWARE OF THIS FOR FURTHER ACTION.

LEGEND

	PIPEWORK IN CEILING SPACE
	PIPEWORK AT HIGH LEVEL
	PIPEWORK AT LOW LEVEL
	PIPEWORK IN FLOOR VOID
SVP	SOIL AND VENT PIPE
CE	CLEANING EYE
CT	CONNECT TO
BU	BUILDERS UPSTAND

SOILS & WASTE NOTES:

- MARLEY FIRE SLEEVE SPC TO BE FITTED ON ALL SOILS AND WASTE PIPEWORK PASSING THROUGH FIRE COMPARTMENT WALLS AND FLOORS.
- ALL SINKS TO BE FITTED WITH 76mm DEEP SEAL TRAPS, BOTTLE TYPE.
- 380 WASTE FROM ALL SINKS, BASINS, BATHS & SHOWERS.
- 1000 WASTE FROM ALL WC CONNECT TO 1000 SVP.
- 380 STANDPIPE FOR ALL DISHWASHERS AND WASHING MACHINES.
- LOCATION OF CONNECTIONS TO BE CONFIRMED BY ARCHITECT.
- CONTRACTOR TO INCLUDE FOR SOILS AND WASTES CONNECTIONS TO BATHROOM FITTINGS.
- ALL WASTE AND OVERFLOW PLUMBING PRODUCTS TO BE OF MFP MANUFACTURE.
- ALL SINKS TO BE FITTED WITH SPACE SAVER DOUBLE BOWL ANTI-SIPHON TRAP SETS (MODEL:SSK2).
- ALL STAND PIPES TO BE FITTED WITH 76mm DEEP SEAL TRAP SETS.
- CONTRACTOR TO INCLUDE FOR CONNECTION OF VENTILATING STACK TO DISCHARGE STACK AT EACH FLOOR LEVEL AND BEFORE AND AFTER ANY OFFSET IN THE DISCHARGE STACK.
- SOILS & WASTE TO COMPLY WITH BS EN 12056-2:2000
- RODDING EYE/ACCESS POINTS SHALL BE INSTALLED AT EACH BEND & CHANGE IN DIRECTION.

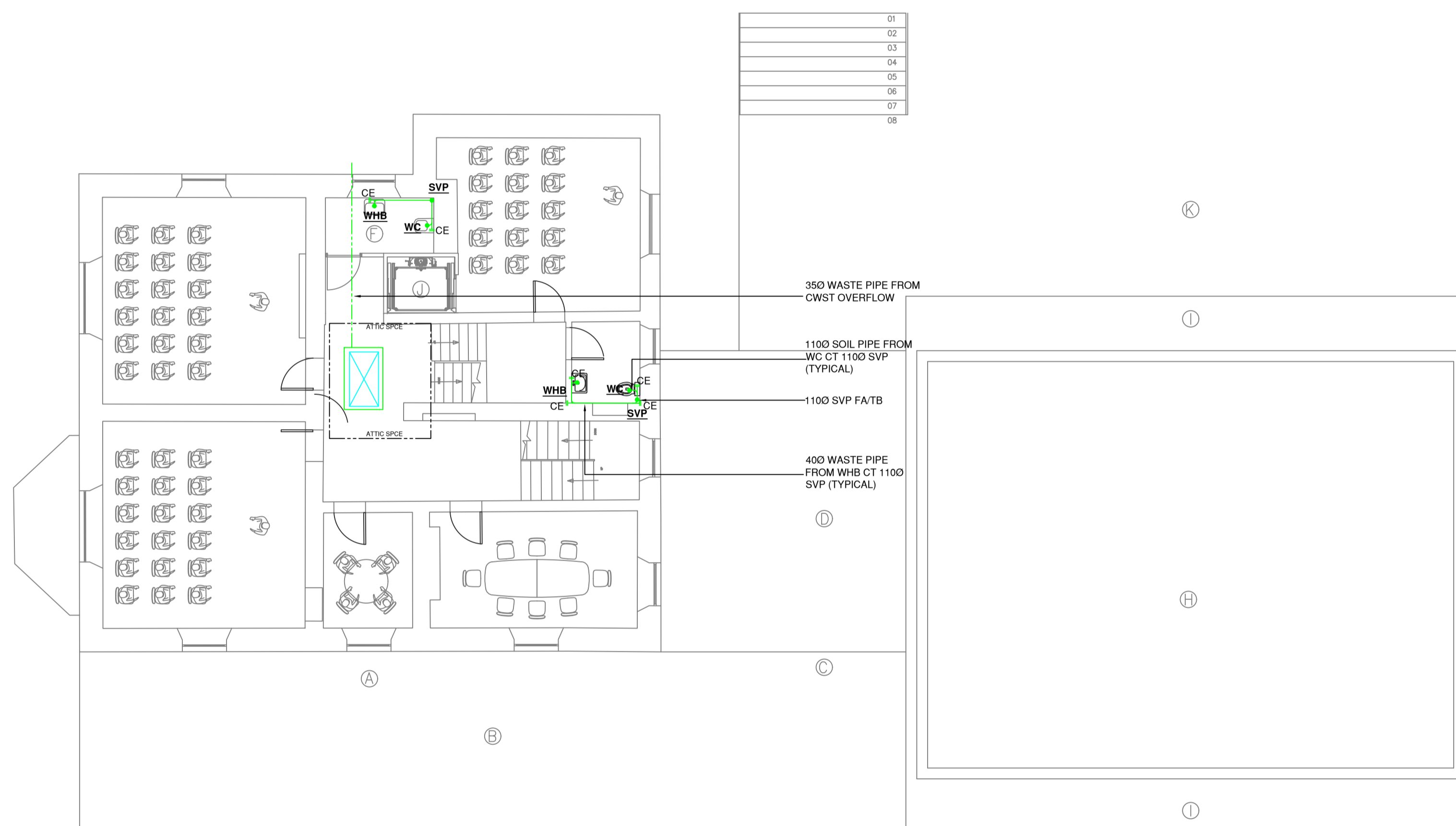

T01	DP	ISSUED FOR TENDER	22.08.2025
T	JW	ISSUED FOR TENDER	05.06.2025

REV	BY	DESCRIPTION	DATE
-----	----	-------------	------

PROJECT:
22195
DAN BREEN HOUSE
TIPPERARY

www.delapandwaller.com Antrim: T +44 (0) 28 9448 3800
info@delapandwaller.com Dublin: T +353 (0) 1 535 5900
London: T +44 (0) 20 8059 7373

CLIENT:
TIPPERARY COUNTY COUNCIL
NORTH TIPPERARY CIVIC OFFICES, LIMERICK ROAD,
KNOCKANPIERCE, NENAGH, CO. TIPPERARY

ARCHITECT:
ROBIN LEE ARCHITECTURE

SCALE AT A1: 1:100	CHK: JW DES: SVB	APP: JW DRW: SVB
------------------------------	-----------------------------------	-----------------------------------

WORK PACKAGE:
M&E DESIGN

DRAWING TITLE:
SOILS & WASTE SERVICES LAYOUT -
FIRST FLOOR

DRAWING NUMBER:
22195-L01-DR-DLW-M-402

STATUS: TENDER	REV: T01
--------------------------	--------------------